

REV	ECN No.	DESCRIPTION	DESIGN	DATE
A	-	NEW RELEASE		2018.01.08

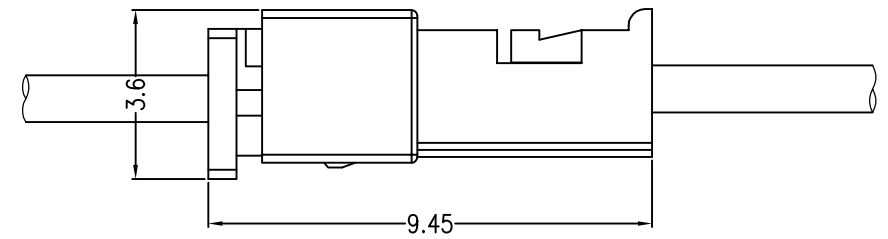

### Assembly Layout

- Main Specifications**
- Poles : 02 to 16
  - Contact resistance :  $\leq 20\text{m}\Omega$
  - Insulation resistance :  $\geq 100\text{M}\Omega$
  - Rated voltage : 125V AC DC
  - Rated current : 1.0A AC DC
  - Withstand voltage : 500V AC/minute
  - Temperature Range :  $-25^\circ\text{C} - +105^\circ\text{C}$

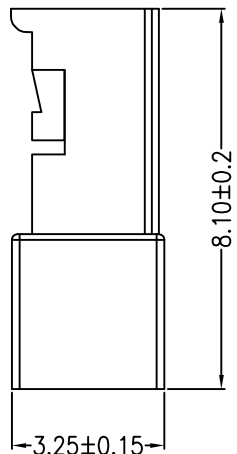
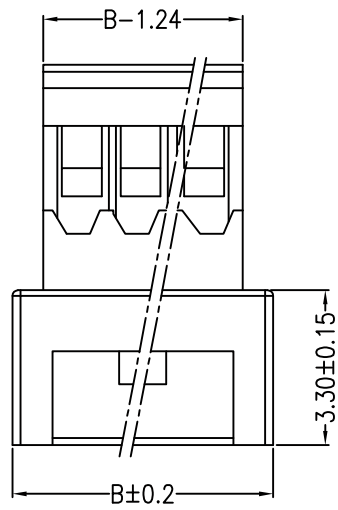
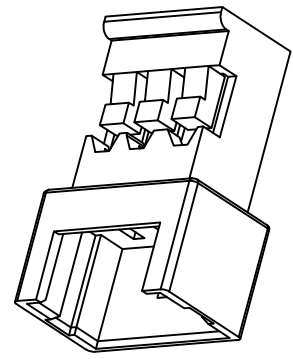
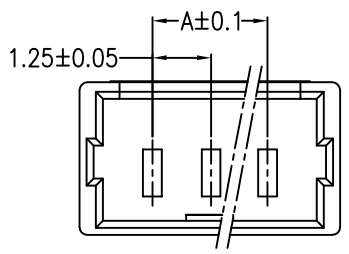

Circuits	Dimensions (mm)	
	A	B
02	1.25	4.20
03	2.50	5.45
04	3.75	6.70
05	5.00	7.95
06	6.25	9.20
07	7.50	10.45
08	8.75	11.70
09	10.00	12.95
10	11.25	14.20
11	12.50	15.45
12	13.75	16.70
13	15.00	17.95
14	16.25	19.20
15	17.50	20.45
16	18.75	21.70

ITEM	COMPONENT	Q'TY	MATERIAL	FINISH
C				
B				
A	HOUSING	1~16 PCS	PA66	COLOR:WHITE

<b>LEDscconn</b>			TITLE: 1.25mmPITCH Housing	
.X±0.35	X.±	USE: CUSTOMER	PART NO.:	
.XX±0.25	.X±			
.XXX±0.15	.XX±	APPD:	DWG NO.:	
--	--	CHKD:		
UNITS: mm		DR:	SCALE 1 : 1	SHEET 1 / 1