

SPECIFICATION:

Circuit: Push (ON)
 Current Rating: 30mA
 Voltage Rating: 30V DC
 Dielectric Strength: 500VAC /1 minute
 Contact Resistance: 100mΩ Max.
 Operating Force: 200±50gf
 Total Travel: 0.7±0.2mm
 Life: 100,000 cycles Min.
 Operating temperature: +10°C~+60°C

Cap Color					
CODE :	R	Y	G	B	L
Color:	Red	Yellow	Green	Black	Blue

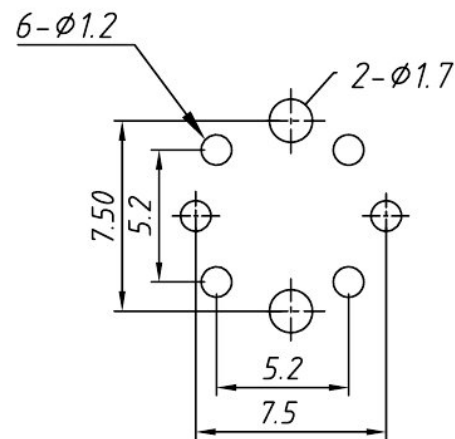
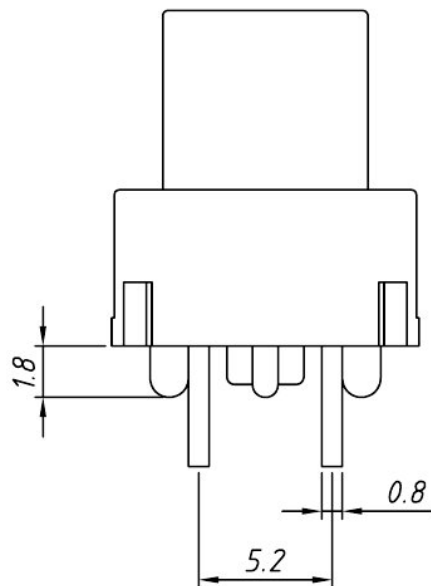
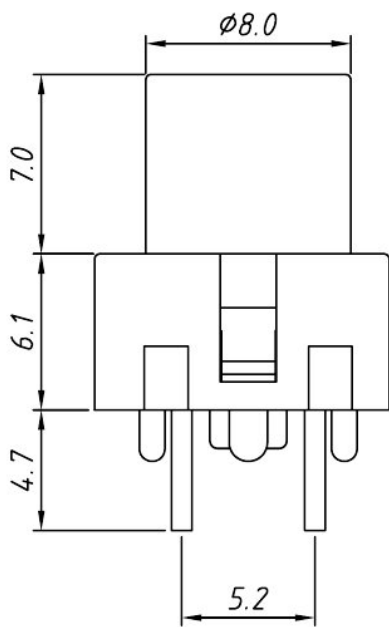

PCB LAYOUT

GENERAL	.X ±0.30	UNITS:	mm	Description:	12mm Reset Tact Switch
TOLERANCE	.XX ±0.15	Size:	A4	Item code:	
ANGLE TOLERANCE	±1°	Draw by:		CONNTHERM	
PROJECTION		Check by:			