

RoHS Compliance

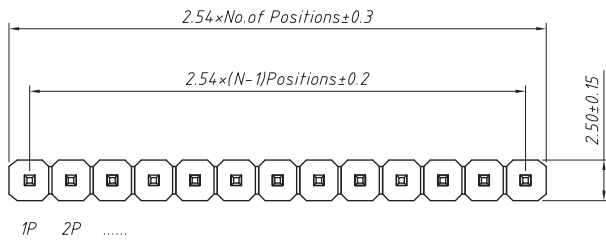

Recommended P.C.B Layout (Top Side)
(PCB BOARD TOLERANCE ± 0.05)

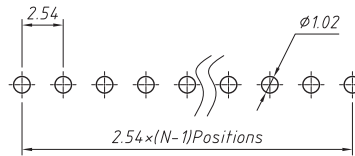

Material:
Standard: PA6T
Contact: Brass
Insulator: Polyester, UL94V-0

Electrical Characteristics:
Rated Current: 3AMP
Contact Resistance: 20mΩ Max
Withstand Voltage: 1000V AC/DC
Insulator Resistance: 1000MΩ Min

Mechanical
Operating Temperature: -40°C ~ +105°C
Max. Processing Temp: 180°C for 30-60 seconds
(200°C for 10 seconds)

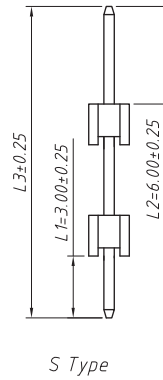
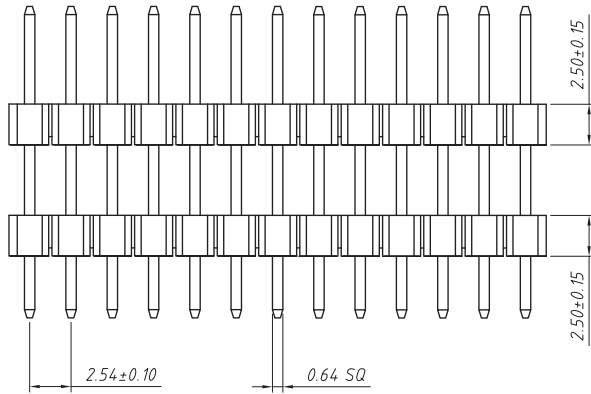

Dimension antitheses list (mm)				
ITEM	L1	L2	L3	Plastic Height
Standard	3.0	6.0	19.4	2.50
Nonstandard				

ANGLE TOLERANCE	PROJECTION	Description:	2.54mm Pin Header
±3°			Single layer, Straight Pin, 1xN Pin
GENERAL TOLERANCE	UNITS	mm	CONN THERM
x.x ±0.30	SHEET SIZE	A4	
x.xx ±0.20	Draw:	Daniel 2018-07-10	
x.xxx ±0.10	Check:	Daniel 2018-07-10	