



IGS-182GP

Industrial 8+2 port unmanaged Ethernet switch with 8x10/100/1000Base-T(X) with 2x100/1000Base-X SFP port

Features

- Supports 8 ports 10/100/1000 Base-T(X)
- Support 2 ports 100/1000Base-X
- Supports auto-negotiation and auto-MDI/MDI-X
- Supports store and forward transmission
- Supports flow control
- Compact size for easily installation
- Rigid IP-30 housing design
- DIN-Rail and wall mounting enabled



Introduction

IGS-182GP is unmanaged Ethernet switch with 8x10/100/1000Base-T(X) with 2x100/1000Base-X ports. With very compact size of housing, you can install IGS-182GP easily. In addition, IGS-182GP is with rigid IP-30 housing design and can operate under harsh environment. The extended operating temperature range from -40 °C to 75°C is ready and can satisfy most requirement of operation.

Dimension

Unit =mm (Tolerance ±0.5mm)

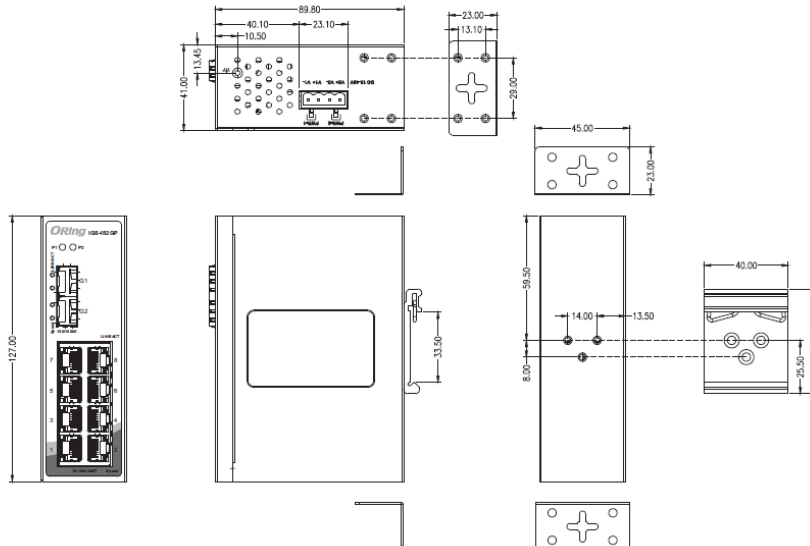

Specifications

| ORing Switch Model | IGS-182GP |
|--|---|
| Physical Ports | |
| 10/100/1000 Base-T(X) Ports in RJ45 Auto MDI/MDIX | 8 |
| 100/1000Base-X ports | 2 |
| Technology | |
| Ethernet Standards | IEEE 802.3 for 10Base-T IEEE 802.3u for 100Base-TX and 100Base-FX IEEE 802.3ab for 1000Base-T IEEE 802.3z for 1000Base-X IEEE 802.3x for Flow control |
| MAC Table | 4K |
| Processing | Store-and-Forward |
| Switch Latency | <7us |
| Switch Bandwidth | 20G bps |
| Packet buffer size | 1.5M bits |
| Jumbo Frame | 9216 Bytes |
| LED indicators | |
| Power Indicator | Green for PWR1, PWR2 |
| 10/100/1000Base-T(X) RJ45 Port Indicator | Upper for Link/Act indicator, Green for port Link/Act. Lower for speed indicator, Green for 1000Mbps, Amber for 100Mbps, OFF for 10Mbps |
| 100/1000Base-X SFP Port Indicator | Upper for Link/Act indicator, Green for port Link/Act. Green for 1000Mbps, Amber for 100Mbps |
| Power | |
| Input Power | Dual 12~48 VDC voltage power input on 4-pin terminal block |
| Power Consumption (Typ.) | <5Watts,12-48VDC: 0.41A-0.11A |
| Overload Current Protection | Present |
| Reverse Polarity Protection | Present |
| Physical Characteristic | |
| Enclosure | IP-30, Metal |
| Dimension (W x D x H) | 41 (W) x 89.8 (D) x 127 (H)mm |
| Weight (g) | 400g |
| Environmental | |
| Storage Temperature | -40 to 85°C (-40 to 185°F) |
| Operating Temperature | -40 to 75°C (-40 to 167°F) |
| Operating Humidity | 5% to 95% Non-condensing |
| Regulatory approvals | |
| EMC | CE EMC (EN 55024, EN 55032), FCC Part 15 B |
| EMI | EN 55032, CISPR32, EN 61000-3-2, EN 61000-3-3, FCC Part 15 B class A |
| EMS | EN 55024 (IEC/EN 61000-4-2 (ESD: Contact 6KV, Air 8KV), IEC/EN 61000-4-3 (RS: 3V), IEC/EN 61000-4-4 (EFT Power 2KV, Signal 2KV), IEC/EN 61000-4-5 (Surge: Power 1KV, RJ45 1KV), IEC/EN 61000-4-6 (CS: 3V), IEC/EN 61000-4-8(PFMF), IEC/EN 61000-4-11 (DIP)) |
| Shock | IEC60068-2-27 |
| Free Fall | IEC60068-2-31 |
| Vibration | IEC60068-2-6 |
| Safety | UL61010-1;UL61010-2-201 |
| MTBF | 1056,516 hours |
| Warranty | 5 years |

Ordering Information

IGS-1A|B|GP

| Code Definition | 10/100Base-T(X) Port Number | Additional Port Number |
|-----------------|-----------------------------|------------------------|
| Option | - 8: 8 ports | - 0: 0 port |

| Available Model | Model Name | Description |
|-----------------|------------|--|
| | IGS-182GP | Industrial 8-port unmanaged Ethernet switch with 8x10/1001000Base-T(X) with 2x100/1000Base-X SFP ports |

Packing List

- IGS-182GP x 1
- Wall-mount Kit x 1
- Quick Installation Guide x 1
- Din-Rail Kit x 1

Optional Accessories

- PAE-121000, 12VDC/1000mA 12W Power Adapter with universal 100 to 240VAC input, EU plug
- SDR/DRP Series DIN-Rail power supply
- PAA-121000, 12VDC/1000mA 12W Power Adapter with universal 100 to 240VAC input, US plug