

1

2

3

4

5

6

7

FOR
客户名称APPROVED
客户确认签字ATTN
销售负责人

A

A

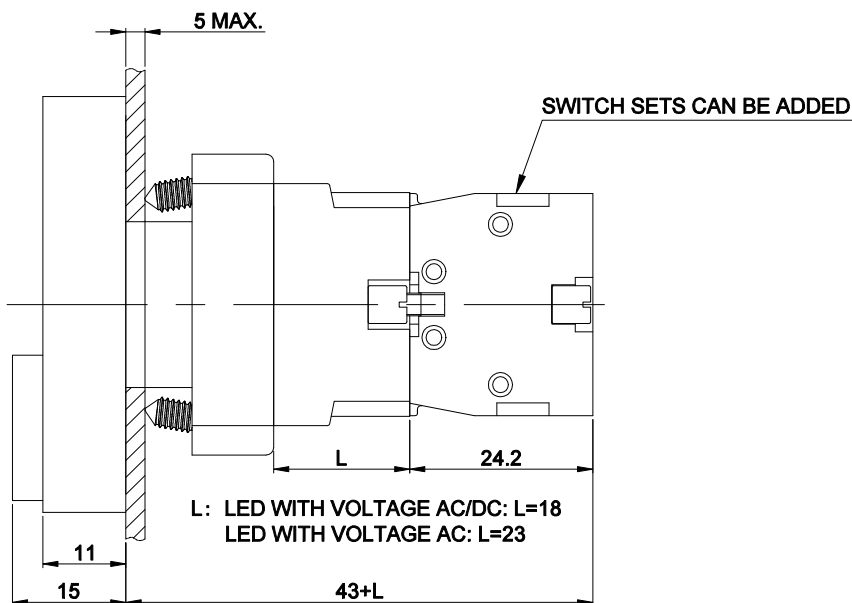

THE SHADED PART IS ILLUMINATED

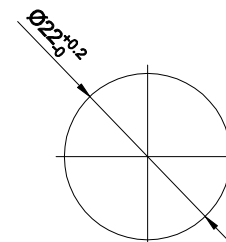
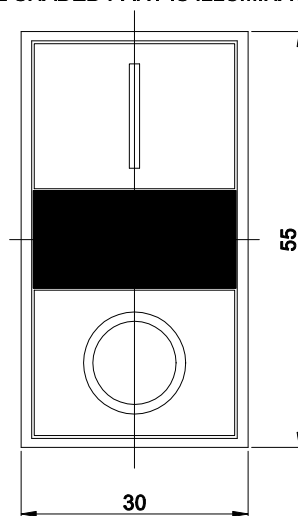

PANEL CUTOUT

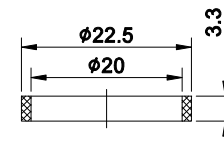

SEAL RING

PART NUMBER: HBY5S-□/▲

B

B

C

C

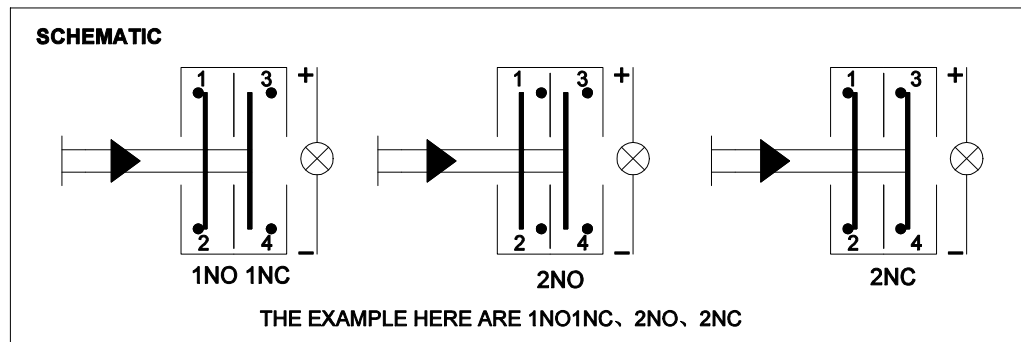

□	OPERATION MODE	▲	LAMP VOLTAGE
20	2NO	6V	AC/DC 6V
02	2NC	12V	AC/DC 12V
11	1NO1NC	24V	AC/DC 24V
		110V	AC/DC 110V
		220V	AC/DC 220V
		AC110V	AC 110V
		AC220V	AC 220V
			OTHER VOLTAGE CAN BE MADE TO ORDER

D

D

SPECIFICATIONS:

- SWITCH RATING: AC550V/1.4A, DC220V/0.6A.
- MECHANICAL LIFE: ≥500,000 cycles.
- ELECTRICAL LIFE: ≥50,000 cycles.
- CONTACT RESISTANCE: ≤50mΩ.
- INSULATION RESISTANCE: ≥100MΩ(500VDC).
- DIELECTRIC STRENGTH: 3,000V, RMS 50HZ, 1min.
- OPERATING TEMPERATURE: -25°C~+55°C(NO FREEZING).
- OPERATING FORCE: ABOUT 8N(1NO1NC), 14N(2NO2NC).
- OPERATING TRAVEL: ABOUT 5.5mm.
- IP CLASS: IP40.
- GENERAL TOLERANCE: 0-18mm=±0.25, 18-80mm=±0.52.

MATERIALS:

- CONTACT: SILVER ALLOY.
- BUTTON: ABS.
- BASE: PBT.

E

E

BRAND 品牌

ONPOW 欧宝龙®**红波按钮制造有限公司**

ONPOW PUSH BUTTON MANUFACTURE CO.,LTD.

TITLE 名称	HBY5 SERIES PUSHBUTTON SWITCHES		UNIT 单位	mm	
DWG NO. 图号	HBY5S-D	SCALE 比例	1:1	SIZE 图纸	A4
FILE NAME 档案名称	HBY5双位按钮 .DWG	DRAWN 制图	YDY 2022/04/15	SHEET 张	1/1
		REV. 更改			1

1

2

3

4

5

6

7