

惠州宏利源电器有限公司

HONYONE ELECTRICAL APPLIANCE CO.,LTD

TS12

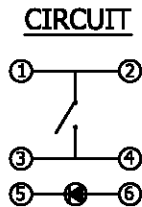
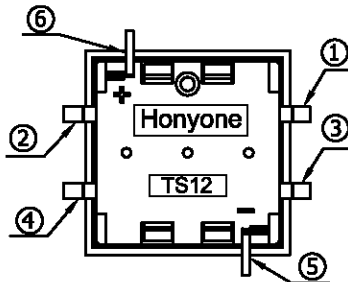
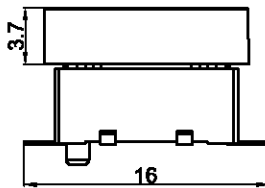
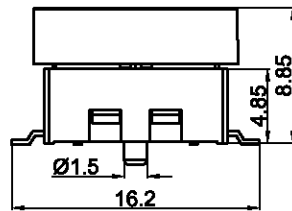
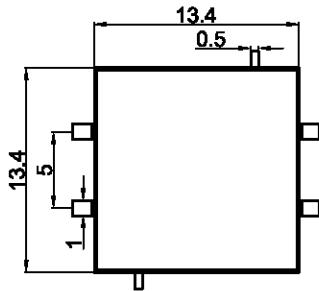

Switch Specifications
 Circuit :SPST
 Current rating :50mA
 Voltage rating :12VDC
 Dielectric withstanding voltage :250VAC for 1 minute
 Contact resistance :100mΩ Max. (Initial)
 Insulation resistance :100MΩ Min.
 Operating force :250±50gf
 Total travel :0.4mm±0.15mm
 Operating life :100,000 cycles Min
 Solder specifications :260° C for 5 seconds
 Function :Momentary
 Operating temperature :-20° C ~ +70° C

P.C.B.LAYOUT

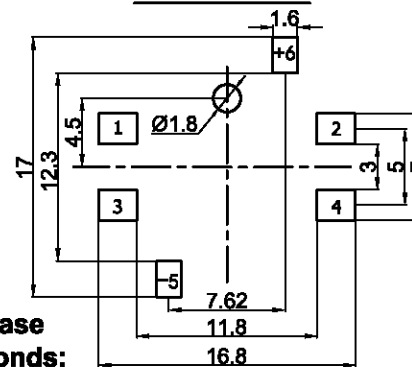

LED Specifications

| W | 白色 | 2.8 | 3.2 | 3.6 | 40 |
|----------------------------|-----|---------|-----|----------------|----|
| RG | 绿色 | 2.8 | 3.2 | 3.6 | 20 |
| | 红色 | 1.8 | 2.2 | 2.4 | 20 |
| U | 蓝色 | 2.8 | 3.2 | 3.7 | 40 |
| G | 纯绿色 | 2.8 | 3.2 | 3.6 | 40 |
| Y | 黄色 | 1.8 | 2.2 | 2.6 | 40 |
| R | 红色 | 1.8 | 2.0 | 2.5 | 40 |
| 灯发光颜色 X Emitted color X | 最小 | 一般 | 最大 | 最大操作电流 (mA) | |
| | | 顺向电压(V) | | | |

Note:

1.This product is strictly prohibited wave soldering and reflow soldering,please use the manual welding processing, temperature of 350°±5°and time is 3±0.5 seconds;
 2.After the product is welded on the PCB board,it is prohibited to use any solvent to clean the PCB board,and avoid the influence of the inner product.

| | | | | | | | | | |
|---------|-------------------------|------------|---------|---------------|---------|------------|---------------|-------------------|-----------------------|
| A5 | 新加焊锡要求说明 | 2016.08.03 | N/A | 公差 TOLERANCES | .X± 0.3 | .XX± 0.15 | 角度 ANGLE ± 1° | 单位 DIMENSION UNIT | mm. |
| A4 | 产品间隙调整, 性能升级 | 2015.05.30 | N/A | 视角 | 比例尺 | NONE | 日期 | 2016.08.03 | 品名 TITLE |
| A3 | 公差变更 | 2015.01.22 | N/A | VIEWING ANGLE | SCALE | NONE | DATE | | 图号 |
| A2 | 电流等级变更 | 2014.08.19 | N/A | 核准 | 核对 | Sinc | 绘图 | | DRAWING NO |
| 版本 VER. | 变更说明 CHANGE DESCRIPTION | 日期 DATE | ECN NO. | APPROVED BY | Richard | CHECKED BY | MASSHAOFEI | | TS12-1R1-X-NN-P |
| | | | | | | | | | TS12-1R1-X-NN-P_CP_A5 |