

Metal Light[®]

Key Characteristics:

- Tactile touch metal buttons
- Change LCD commands quickly and easily
- High quality concentric encoders
- Key size -typically 19mm CtC
- Shortcut bezel keys
- Humidity & condensation
- Vibration and shock proof
- Fully functional touch metal buttons

General Characteristics

- No moving parts – completely sealed against the environment
- Enhanced Touch activated - operation by hand, gloves or tools
- Switching functions - momentary, toggle, prolonged, continuous, timer and programmable
- Optional Smart Switch technology - self-diagnostic, Wi Fi, Bluetooth and IoT capabilities



Electrical Data

Actuation Force	2-5 N
Input Voltage	12VDC
Operating Input Current	0.8A max
Relay Switching Voltage	0-240 AC/DC
Relay Switching Current	10A max
Illuminated surface	RGB

Mechanical Data

Housing Materials	Aluminum 6061 T651
Front Panel Material	STS Metal light
Relay Box Material	STL/ABS
Relay box wire connection	Terminal blocks 14-16 AWG
Finish	Black Anodize

Environmental Data

Operating Temperature	-20°C to +75°C
Storage Temperature	- 40°C To +85°C
IP Protection	Front panel: IP68 Relay Box : IP65

Technical Drawing

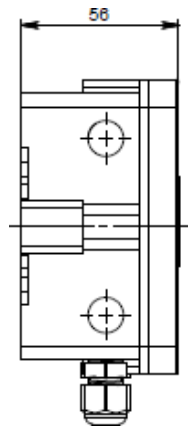
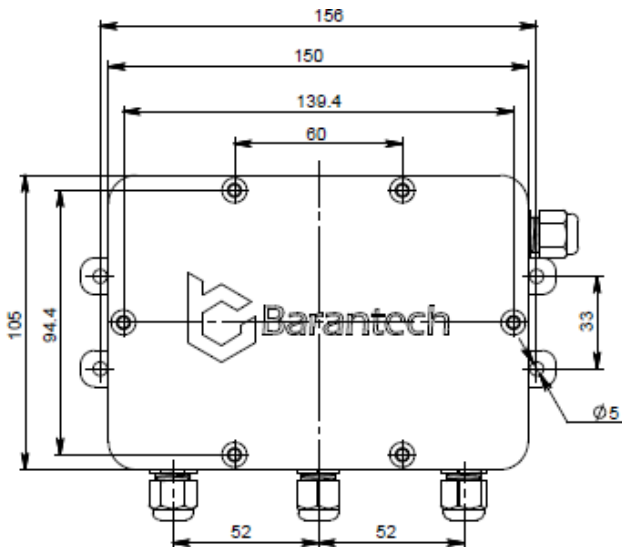
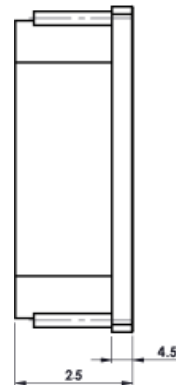
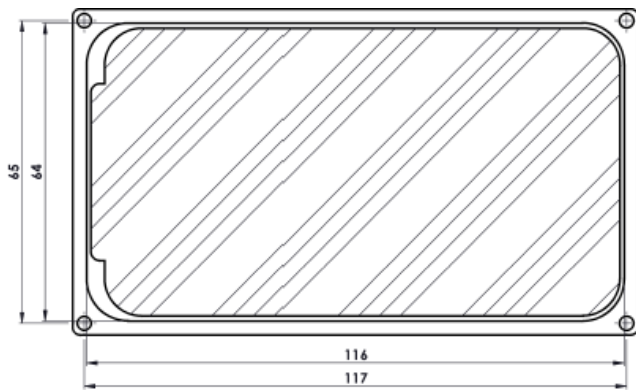
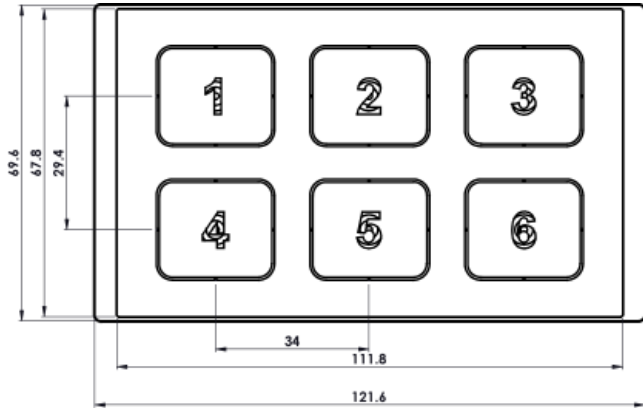

*The specifications, descriptions and illustrations indicated in this document are based on current information. All content is subject to modifications and amendments. Users should evaluate the suitability and test each product selected for their own applications.