

REV.	LOCAS.	DESCRIPTION	DATE	DRAWN
01		INITIAL RELEASE.	2007.09.15	张荣

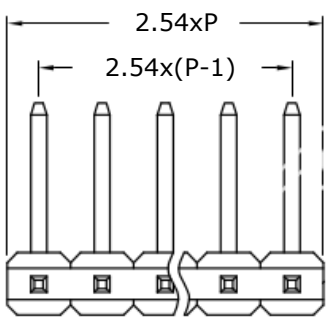

Specifications

Current Rating: 3Amp
 Insulation Resistance: 1000M Min. Ω
 Dielectric Withstanding: 600V AC
 Contact Resistance: 20m Max Ω
 Operating Temperature: -40°C to +105°C

Materials

Contact Material: Brass
 Insulation Material: Polyester, UL 94V-0
 PBT
 All materials must be GP materials

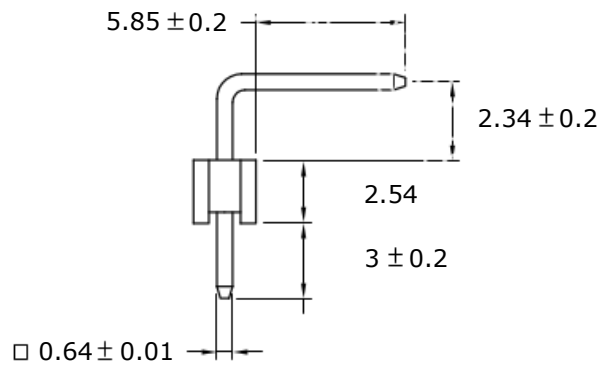
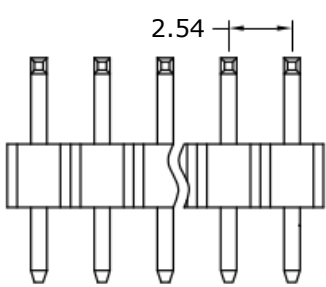

Recommended P.C.Board

Hole Layout
 (Tolerance ± 0.05)

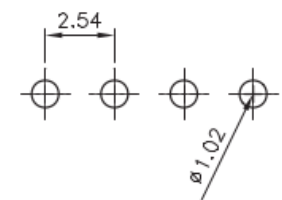

CIXI ULO ELECTRONICS CO., LTD

GENERAL TOLERANCE

X.* $\pm 5.0^\circ$	X. ± 0.30
.X* $\pm 3.0^\circ$.X ± 0.25
.XX* $\pm 2.0^\circ$.XX ± 0.15
.XXX* $\pm 1.0^\circ$.XXX ± 0.10

DESIGN: 张荣

DATE: 2007.09.15

DWG. NO.

TITLE.

2.54 PIN HEADER
 SINGLE ROW R/A D TYPE
 BASE 2.54H

CHECKED:

DATE:

AUDITED:

DATE:

APPROVED:

DATE:

PART NO.

ULO-PLS40RDU

REV.	UNIT.	SCALE.	PAGE.
01	mm	5:1	1/1

