

DIL..

IC SOCKET 2.54mm(0.100")

Position	Dimension				Position	Dimension			
	A	B	C	D		A	B	C	D
6	7.52	7.62	10.16	7.62	24	30.48	27.94	17.78	15.24
8	10.16	7.62	10.16	7.62	28	35.56	33.02	10.16	7.62
14	17.82	15.24	10.16	7.62	28	35.56	33.02	17.78	15.24
16	20.32	17.78	10.16	7.62	32	40.54	38.10	17.68	15.24
18	22.86	20.32	10.16	7.62	40	50.80	48.26	17.78	15.24
20	25.40	22.86	10.16	7.62	42	53.21	50.80	17.68	15.24
24	30.48	27.94	10.16	7.62					

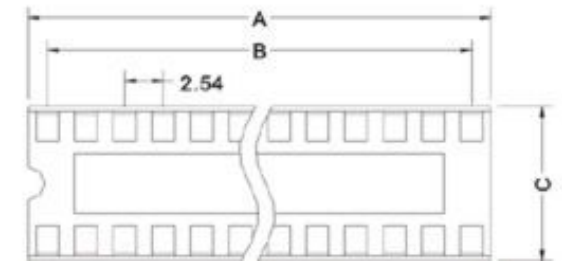
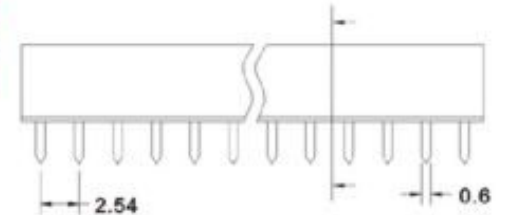
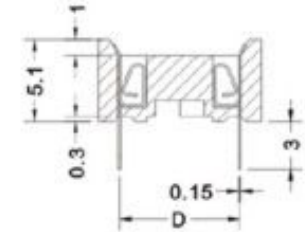

Specifications:

Contact Resistance: 30m Ω max.at DC 100 mA
Insulator Resistance: 1000M Ω min.at DC 500V
Current Rating: 1AMP

Dielectric Withstanding

Voltage: AC 500V For 1 minute
Operating Temperature: -55° C--+105° C
Contact: Phosphor Bronze **Tin Plated**
Housing: PBT &30% Glass Fiber(UL 94V-0)