

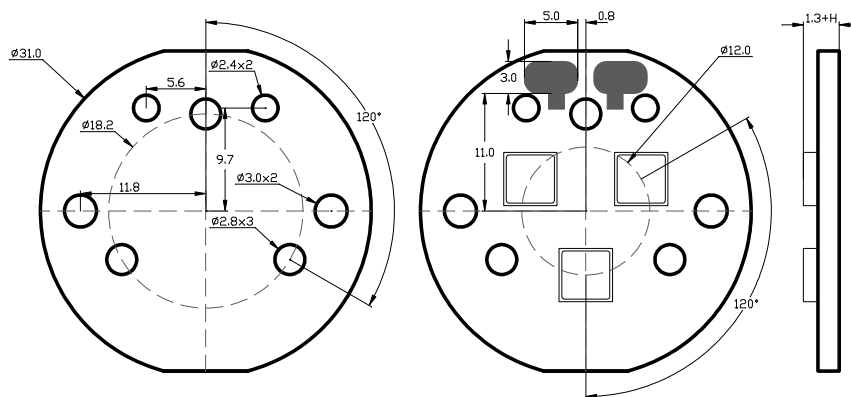

SHORT DESCRIPTION

- Round MCPCB board with 31 mm diameter
- Three LEDs connected in series
- Designed for Cree Xlamp High-Power LEDs MX-3, MX-3S, MX-6, MX-6S
- Compatible Lenses: Ledlink LL03CR-EKXXL family





PRODUCT NOMENCLATURE

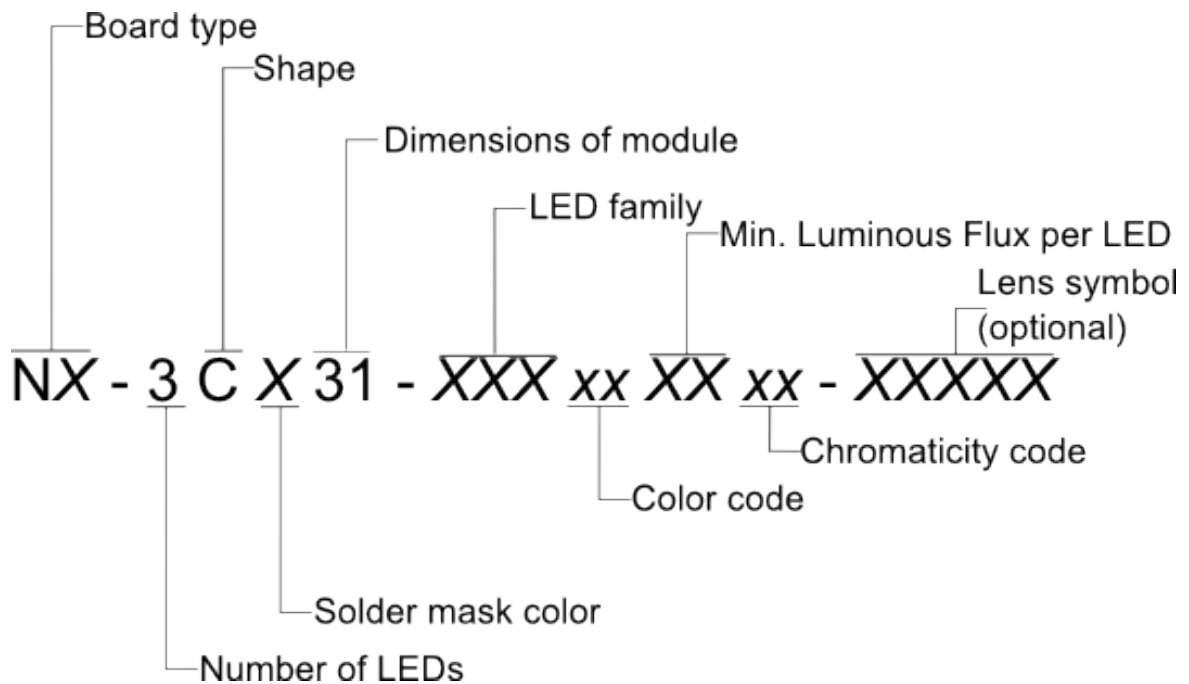

Board Type¹

NX - 3CX31- XXXxxXXxx- XXXXX

	H [mm]	Material	Dielectric thermal conductivity [W/(m·K)]	Dielectric thickness [μm]
NV	2	1060 Alloy	1.5	80
NS	1.6			
NT	2	5052 Alloy	2	60
NC	1.6			
NM	2	Cu	3	60
NB	2	5052	depends on design ² 10÷50	60



Shape

NX- 3C X31- XXXxxXXxx- XXXXX

Shape name	
R	Rectangular
C	Round
S	Star
P	Polygonal

Soldermask Color³

NX- 3CX 31- XXXxxXXxx- XXXXX

Color name	
B	Black
O	Orange
W	White

LED Family

NX- 3CX31- XXX xxXXxx- XXXXX

	Description	Suggested Board Type
MX3	Cree Xlamp MX-3 Type	NV, NS, NT, NC, NM
MX3S	Cree Xlamp MX-3S Type	NV, NS, NT, NC, NM
MX6	Cree Xlamp MX-6 Type	NV, NS, NT, NC, NM
MX6S	Cree Xlamp MX-6S Type	NV, NS, NT, NC, NM

Color

NX- 3CX31- XXXxx XXxx- XXXXX

Color name	CTT Range [K]		Led families
	min	max	
WC Cool White	5000	8300	MX3, MX3S, MX6, MX6S
80 80-CRI White	2600	4300	MX6, MX6S
WW Warm White	2600	4300	MX3, MX3S, MX6, MX6S



Minimal Luminous Flux per LED

NX- 3CX31- XXXxxXX xx- XXXXX

Please refer to proper CREE Binning & Labeling documentation(located at <http://www.cree.com/products/xlamp.asp>) paragraph "Luminous or radiant flux group".

Chromaticity

NX- 3CX31- XXXxxXXxx - XXXXX

Please refer to proper CREE Binning & Labeling documentation (located at <http://www.cree.com/products/xlamp.asp>) paragraph "Chromaticity or dominant-wavelength group".

Lens Symbol (optional)⁴

NX- 3CX31- XXXxxXXxx- XXXXX

Following table contains some of example lenses for nGine.

Family	Example	Mounting	Manufacturer
LL03CR-EKXXL	EK40L, EK60L	Put in	 LedLink Adding LEDs to the Real World

Ordering Code Example

NV-3CW31-MX6WCQ52B – 2 mm 1060 Alloy board with white soldermask, 3 MX6 cool white LEDs, Q52B bin,

NV-3CB31-MX6WCQ52B-EK40L – 2 mm 1060 Alloy board with black soldermask, 3 MX6 cool white LEDs, Q52B bin, LL03CR-EK40LL Ledlink lens.

ENVIROMENTAL CAUTION



It is prohibited to dispose of obsolete and waste electrical and electronic equipment together with regular household wastes. They should be properly sorted and recycled. old electrical and electronic equipment should be returned to a waste collection point established by a waste-management service. Waste electrical and electronic equipment can be broken down to base materials and then recycled. For more information regarding waste management please contact your local authorities waste-management service or the seller of electrical and electronic devices.

NOTES

¹ Another thickness available on request.



²Blind holes technology.

³Another soldermask color available on request.

⁴More lenses available on request.