

REV.	LOCAS.	DESCRIPTION	DATE	DRAWN
01	NEW	BATCH PRODUCTION INITIAL RELEASE.	2014.10.21	邱國強

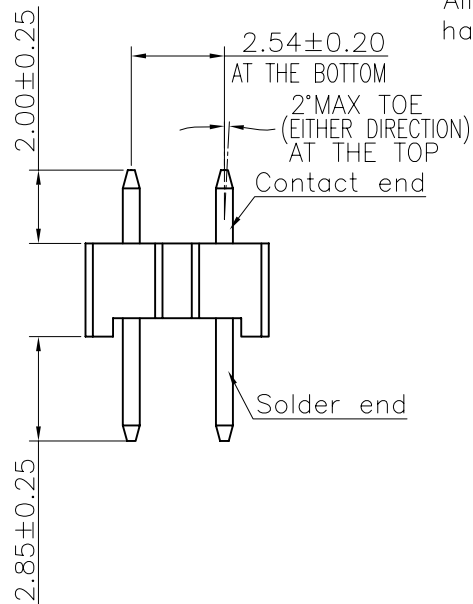

Specifications
 Current Rating:1.0Amp
 Insulation Resistance:1000MΩMin.
 Dielectric Withstanding Voltage:300VAC
 Contact Resistance:20mΩMax.
 Operating Temperature:-40°C to +105°C
 Materials
 Contact Material:Brass
 Insulator Material:High Temperature Thermoplastic, UL 94V-0 LCP or the equivalent material
 All materials must meet Greenconn hazardous substances control standards.

Recommended P.C.Board Layout
 (Tolerance:±0.05)

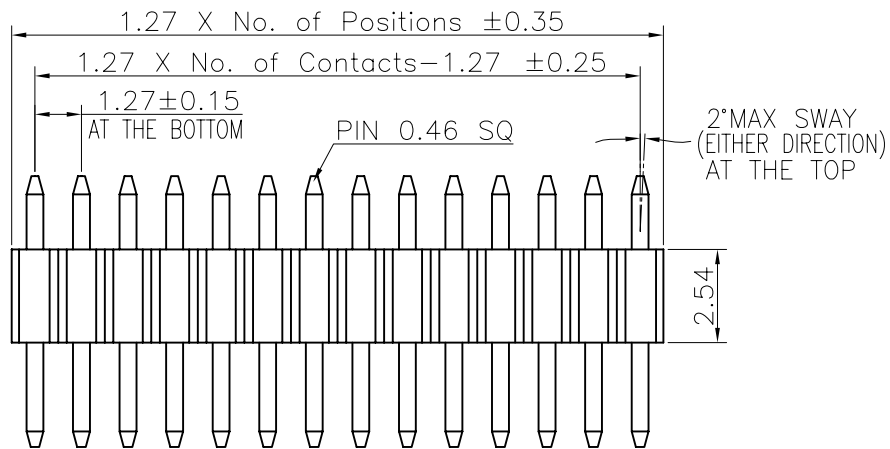
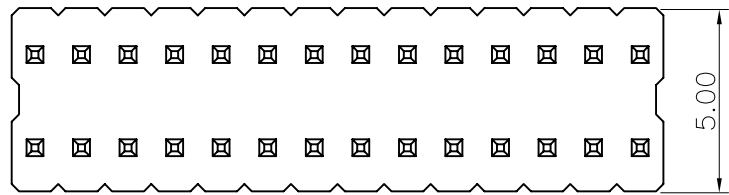
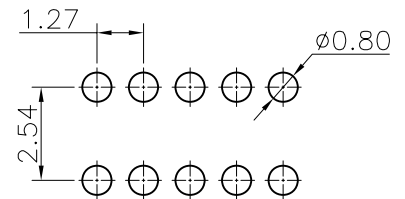

Ordering Information

G PEA201 - XX XX A 088 C 1 B X

No. of Pins per Row: 02~50
 Standard Plating: 02=Gold Flash
 Selective Plating: 01=Tin, 05=Gold Flash/Tin
 Color: 1=Black
 Standard Packing: A=box
 Selective Packing: C=Tube

格稜股份有限公司
Greenconn Corporation

GENERAL TOLERANCE	
X.*±5.0°	X.±0.30
.X*±3.0°	.X±0.25
.XX*±2.0°	.XX±0.15
.XXX*±1.0°	.XXX±0.10

DESIGNED: 邱國強	DATE: 2014.10.21
CHECKED: 曹熙	DATE: 2014.10.21
CO SIGNED: 李紹秀	DATE: 2014.10.21
APPROVED: 李輝	DATE: 2014.10.21

DWG. NO.	GPEA201-CA88CB
PART NO.	GPEA201-XXXXA088C1BX

TITLE.
 1.27x2.54 PIN HEADER
 DUAL ROWS DIP TYPE
 CONNECTOR

REV.	UNIT.	SCALE.	PAGE.
01	mm	5:1	1/1