

**Product number C10921\_GT4-S**

Family	Gt4
Type	Lens array
LED	XP-E
Color	Clear
Diameter	35 mm
Height	9 mm
Style	Round
Optic Material	PMMA
Holder Material	-
Fastening	["pin", "glue"]
Status	Production ready

FWHM	18 degrees
Efficiency	88 %
cd/lm	4.850
Gerber File	Available

MR11 applications

**Product number C10922\_GT4-M**

Family	Gt4
Type	Lens array
LED	XP-E
Color	Clear
Diameter	35 mm
Height	9 mm
Style	Round
Optic Material	PMMA
Holder Material	-
Fastening	["pin", "glue"]
Status	Production ready

FWHM	27 degrees
Efficiency	86 %
cd/lm	2.530
Gerber File	Available

MR11 applications

**Product number C10923\_GT4-W**

Family	Gt4
Type	Lens array
LED	XP-E
Color	Clear
Diameter	35 mm
Height	9 mm
Style	Round
Optic Material	PMMA
Holder Material	-
Fastening	["pin", "glue"]
Status	Production ready

FWHM	37 degrees
Efficiency	87 %
cd/lm	1.670
Gerber File	Available

MR11 applications

**Product number C10975\_GT4-WW**

Family	Gt4
Type	Lens array
LED	XP-E
Color	Clear
Diameter	35 mm
Height	9 mm
Style	Round
Optic Material	PMMA
Holder Material	-
Fastening	["pin", "glue"]
Status	Production ready

FWHM	56 degrees
Efficiency	91 %
cd/lm	1.010
Gerber File	Available

MR11 applications



## PRODUCT DATASHEET

### Gt4 series

last update 26/3/2012

**NOTE: The typical divergence will be changed by different color, chip size and chip position tolerance. The typical total divergence is the full angle measured where the luminous intensity is half of the peak value.**



## PRODUCT DATASHEET

### Gt4 series

last update 26/3/2012

#### GENERAL INFORMATION

- Product series especially designed & optimized for XP-E series of LEDs.
- Special care taken to make light distribution as uniform as possible.
- Lens material optical grade PMMA with high UV and temperature resistance. Allows use of high current and temperature conditions.

Please find more information about used material from below:

[http://ledil.fi/sites/default/files/Documents/Technical/Material/PMMA%20N%20UL94\\_Yellow%20Card.pdf](http://ledil.fi/sites/default/files/Documents/Technical/Material/PMMA%20N%20UL94_Yellow%20Card.pdf)

<http://ledil.fi/sites/default/files/Documents/Technical/Material/PMMA%20N%20PLEXIGLAS-Datasheet.pdf>

D

C

B

A

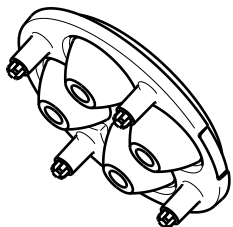

Isometric view  
Scale: 1:1

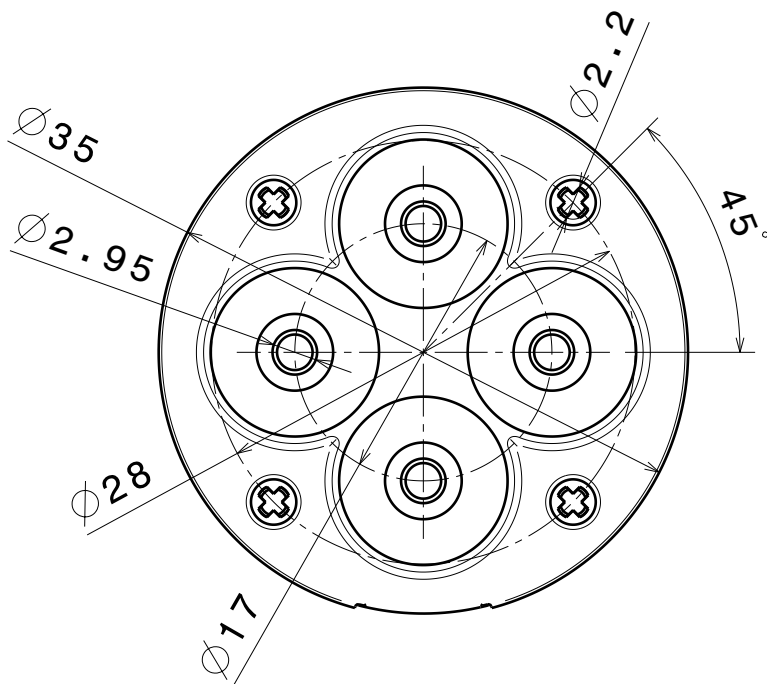

Bottom view

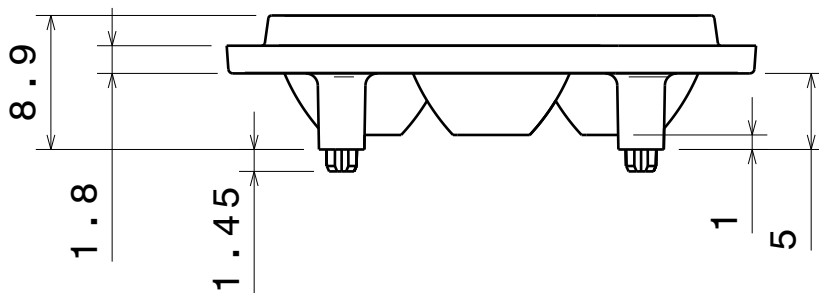

Front view

Material: PMMA

This drawing is our property.  
It can't be reproduced  
or communicated without  
our written agreement.



L  
T  
F  
F

e  
e  
i  
i  
N  
n

d  
h

DRAWING TITLE

Datasheet GT4-XP series Lens

DRAWN BY

DATE

p

30.12.2009

CHECKED BY

DATE

s n

23.12.2009

DESIGNED BY

DATE

hh

23.07.2009

SIZE

A4

DRAWING NUMBER

C10921

REV

1

SCALE

2:1

WEIGHT (g)

SHEET

1/1

D

A

4

4

3

3

2

2

1

1

Ledil Oy C10921\_GT4-XP-S C10921\_GT4-XP-S / LDC (Linear)

Luminaire: Ledil Oy C10921\_GT4-XP-S C10921\_GT4-XP-S  
Lamps: 4 x Cree XP-E (White)

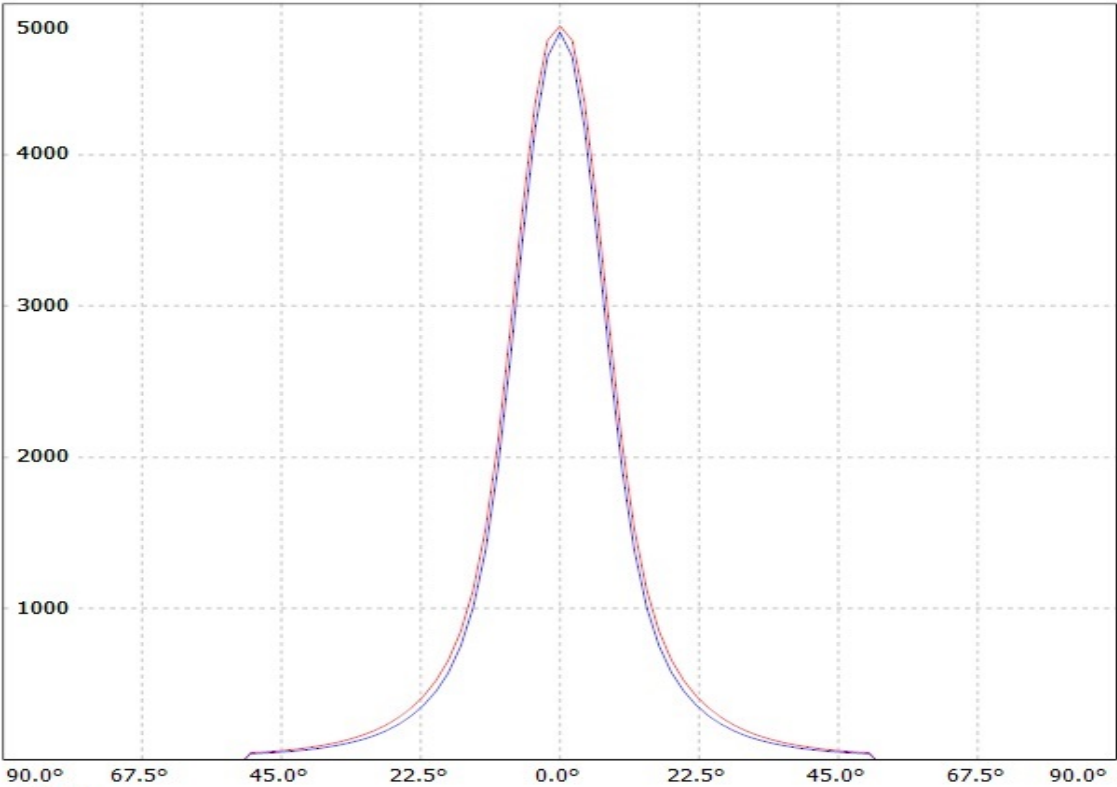

cd/klm

— C0 - C180

— C90 - C270

SIMULATED

Ledil Oy C10922\_GT4-XP-M C10922\_GT4-XP-M / LD

Luminaire: Ledil Oy C10922\_GT4-XP-M C10922\_GT4-XP-M  
Lamps: 4 x Cree XP-E (White)

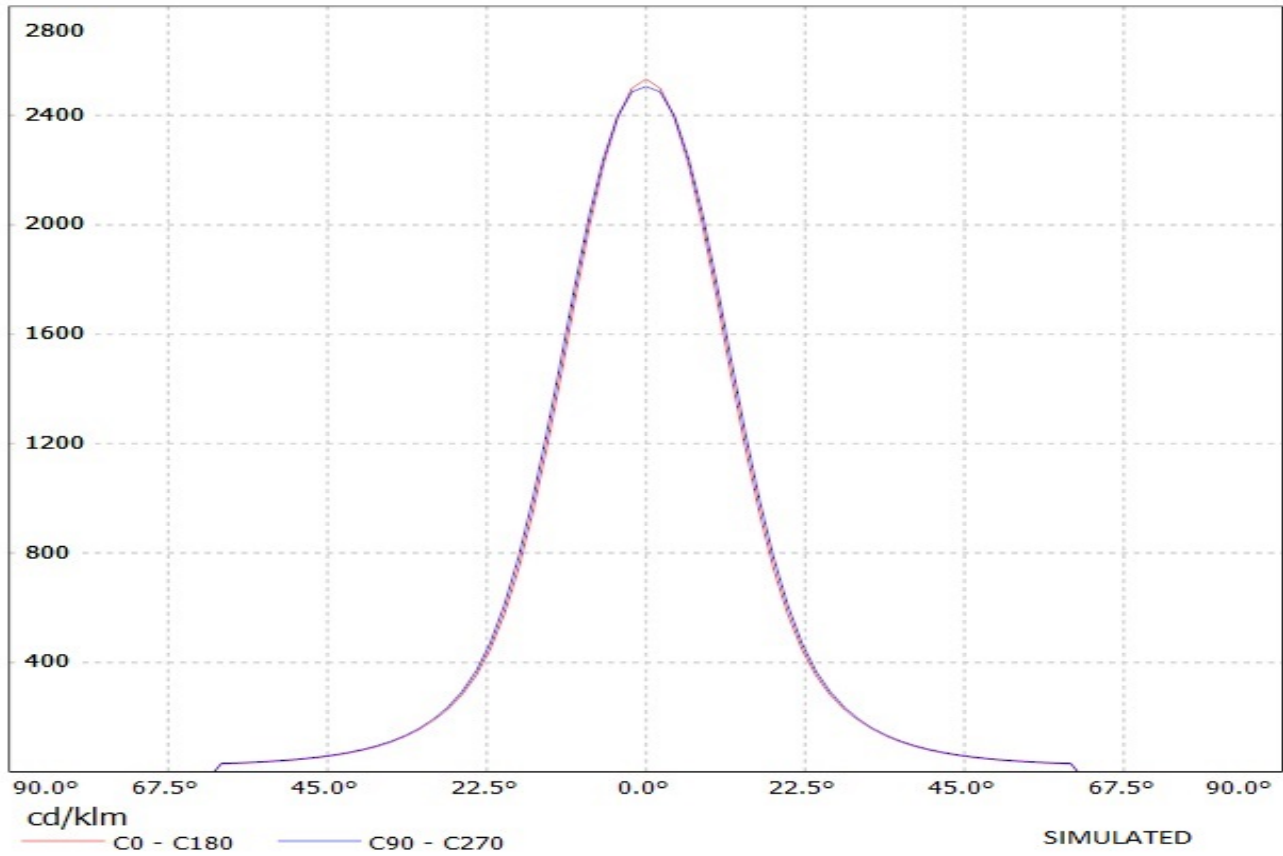

**Ledil Oy C10923\_GT4-XP-W C10923\_GT4-XP-W / LDC (Linear)**

Luminaire: Ledil Oy C10923\_GT4-XP-W C10923\_GT4-XP-W  
Lamps: 4 x Cree XP-E (White)

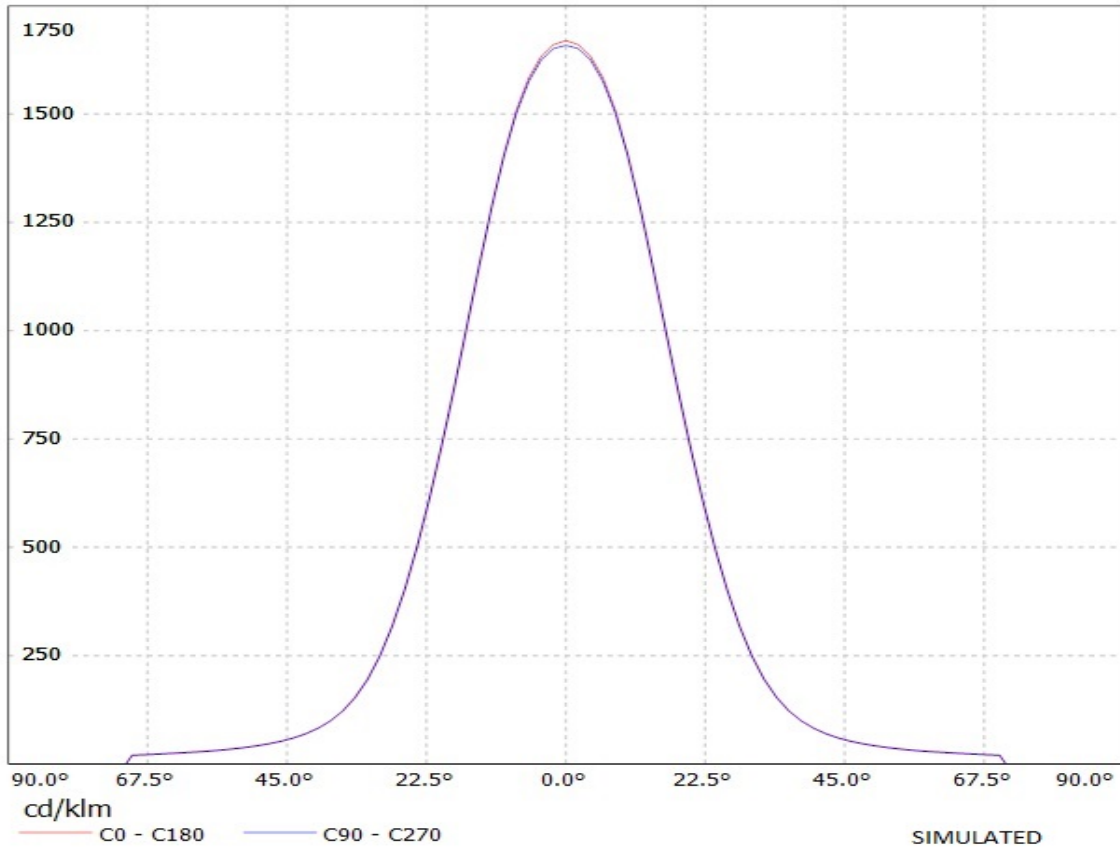

# Ledil Oy C10921\_GT4-XP-S C10921\_GT4-XP-S / LDC (Polar)

Luminaire: Ledil Oy C10921\_GT4-XP-S C10921\_GT4-XP-S

Lamps: 4 x Cree XP-E (White)

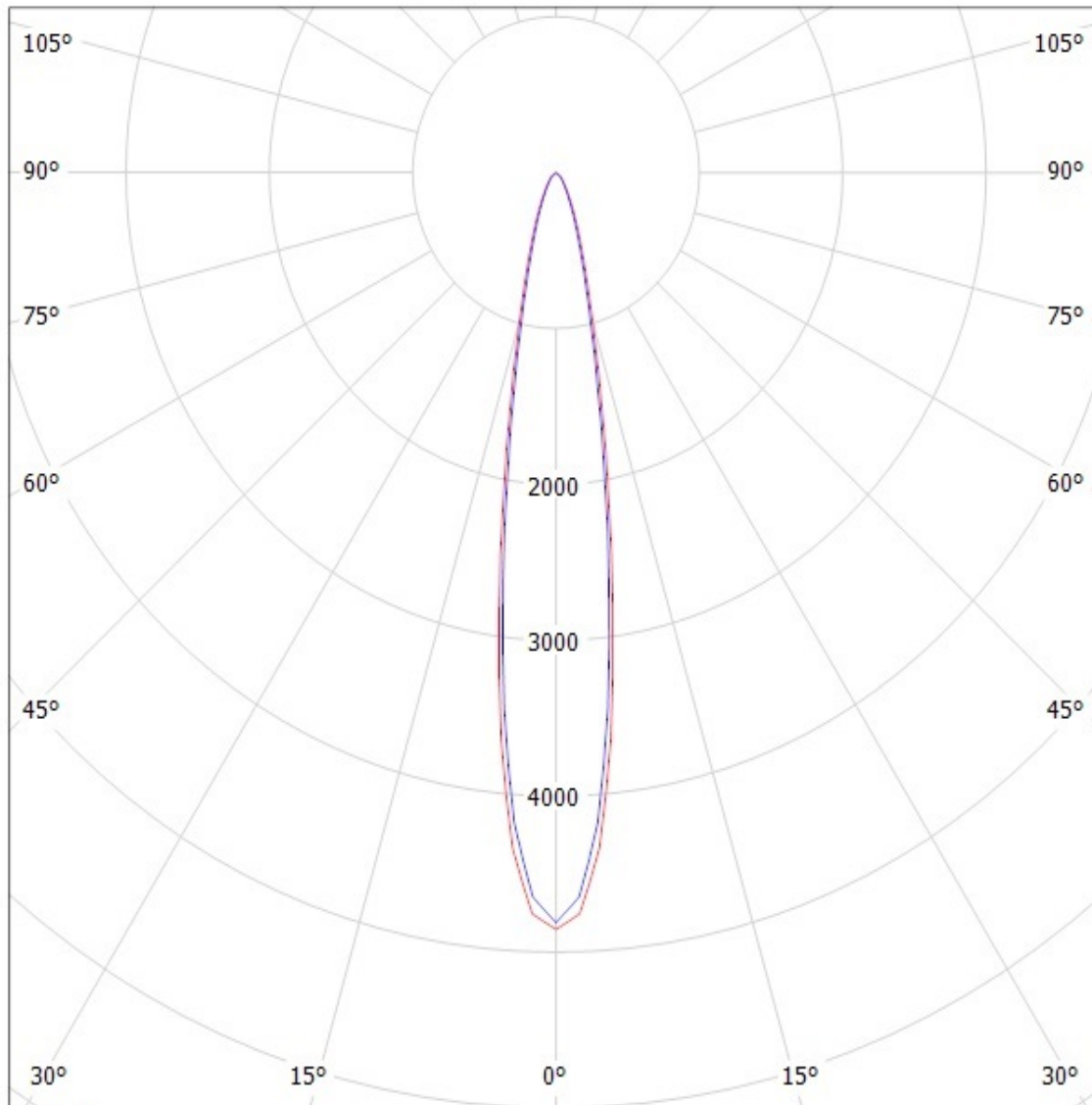

cd/klm

— C0 - C180

— C90 - C270

SIMULATED



# Ledil Oy C10922\_GT4-XP-M C10922\_GT4-XP-M / LDC (Polar)

Luminaire: Ledil Oy C10922\_GT4-XP-M C10922\_GT4-XP-M

Lamps: 4 x Cree XP-E (White)

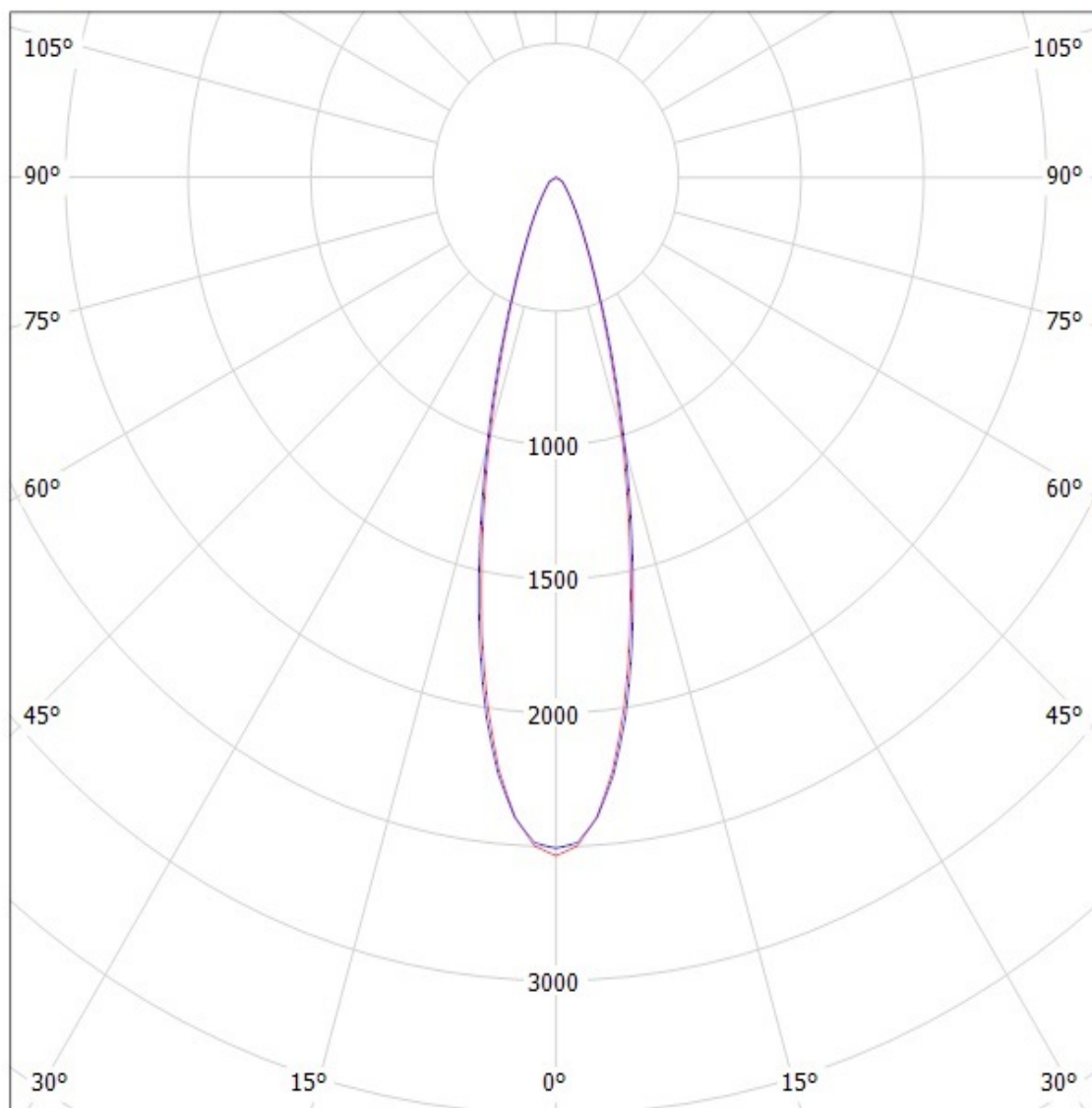

cd/klm

— C0 - C180

— C90 - C270

SIMULATED

# Ledil Oy C10923\_GT4-XP-W C10923\_GT4-XP-W / LDC (Polar)

Luminaire: Ledil Oy C10923\_GT4-XP-W C10923\_GT4-XP-W

Lamps: 4 x Cree XP-E (White)

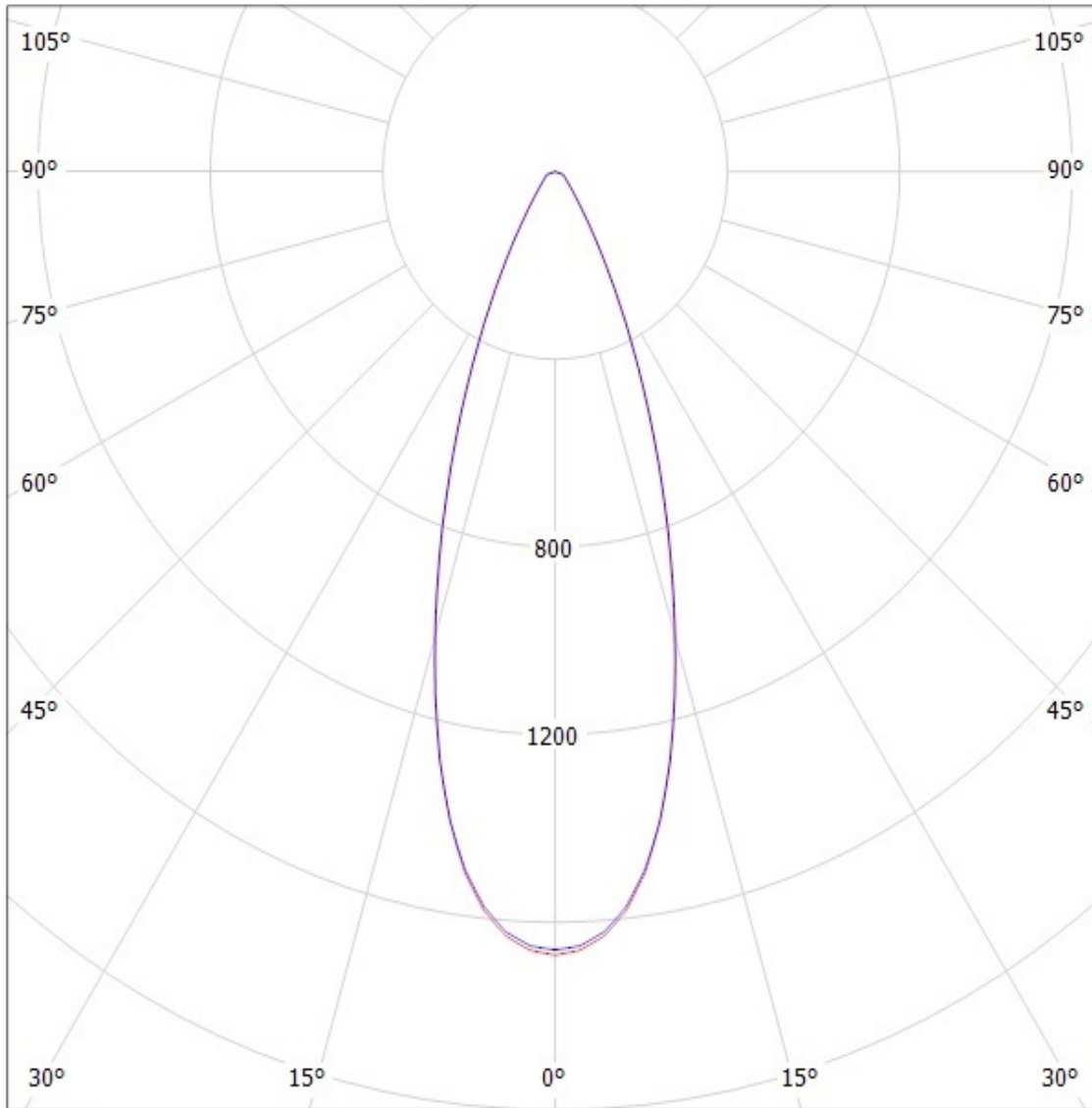

cd/klm

— C0 - C180

— C90 - C270

SIMULATED