

主要技术参数 (Main specifications)

- 使用导线范围 (Wire range): AWG#30~#24 #32~#28
- 额定电压 (Rated voltage): 250V
- 额定电流 (Rated current): 1A
- 接触电阻 (Contact resistance): $\leq 0.01 \Omega$
- 绝缘电阻 (Insulation resistance): $\geq 1000M\Omega$
- 耐压 (Withstanding voltage): 800V.AC
- 温度范围 (Temp range for usage): -25~85℃
- 适应基板厚度 (PC board thickness): 0.8~1.6mm

TP2006J-3(PH)

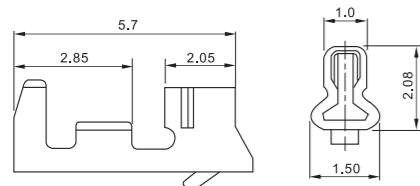

HP2006J-Y(PH)

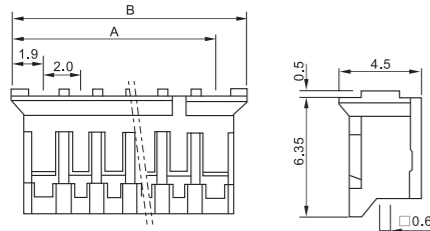

HW2006J-A(PH)

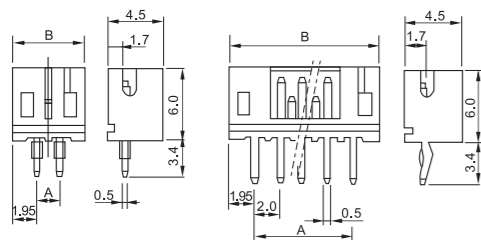

HW2006J-QA(PH)

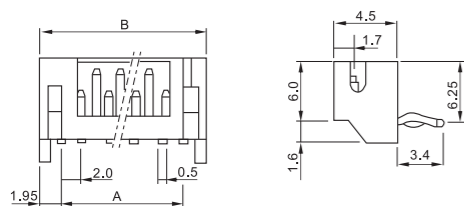

端子 (Terminal) (PH)

| 型号 Type | 适用电线范围 (Wire Range) | | 电线外径 (O.D of Wire ins) | Q' ty/reel |
|--------------|------------------------|-------|---------------------------|------------|
| | mm ² | AWG# | mm | |
| TP2006J-3(A) | 0.032~0.08 | 32~28 | 0.5~0.9 | 8000PCS |
| TP2006J-3(B) | 0.05~0.22 | 28~24 | 0.9~1.5 | 8000PCS |

塑体 (Housing) (PH)

| 线数 (Lines) | 型号 (Type) | 尺寸 Size(mm) | |
|---------------|--------------|-------------|------|
| | | A | B |
| 2 | HP2006J-2Y | 2.0 | 5.8 |
| 3 | HP2006J-3Y | 4.0 | 7.8 |
| 4 | HP2006J-4Y | 6.0 | 9.8 |
| 5 | HP2006J-5Y | 8.0 | 11.8 |
| 6 | HP2006J-6Y | 10.0 | 13.8 |
| 7 | HP2006J-7Y | 12.0 | 15.8 |
| 8 | HP2006J-8Y | 14.0 | 17.8 |
| 9 | HP2006J-9Y | 16.0 | 19.8 |
| 10 | HP2006J-10Y | 18.0 | 21.8 |
| 11 | HP2006J-11Y | 20.0 | 23.8 |
| 12 | HP2006J-12Y | 22.0 | 25.8 |
| 13 | HP2006J-13Y | 24.0 | 27.8 |
| 14 | HP2006J-14Y | 26.0 | 29.8 |
| 15 | HP2006J-15Y | 28.0 | 31.8 |

针座(Wafer) (PH)

| 线数 (Lines) | 型号 (Type) | | 尺寸 Size(mm) | |
|---------------|-----------------------|---------------------|-------------|------|
| | 直式 (Vertical type) | 弯式 (Curved type) | A | B |
| 2 | HW2006J-2A | HW2006J-2QA | 2.0 | 5.9 |
| 3 | HW2006J-3A | HW2006J-3QA | 4.0 | 7.9 |
| 4 | HW2006J-4A | HW2006J-4QA | 6.0 | 9.9 |
| 5 | HW2006J-5A | HW2006J-5QA | 8.0 | 11.9 |
| 6 | HW2006J-6A | HW2006J-6QA | 10.0 | 13.9 |
| 7 | HW2006J-7A | HW2006J-7QA | 12.0 | 15.9 |
| 8 | HW2006J-8A | HW2006J-8QA | 14.0 | 17.9 |
| 9 | HW2006J-9A | HW2006J-9QA | 16.0 | 19.9 |
| 10 | HW2006J-10A | HW2006J-10QA | 18.0 | 21.9 |
| 11 | HW2006J-11A | HW2006J-11QA | 20.0 | 23.9 |
| 12 | HW2006J-12A | HW2006J-12QA | 22.0 | 25.9 |
| 13 | HW2006J-13A | HW2006J-13QA | 24.0 | 27.9 |
| 14 | HW2006J-14A | HW2006J-14QA | 26.0 | 29.9 |
| 15 | HW2006J-15A | HW2006J-15QA | 28.0 | 31.9 |

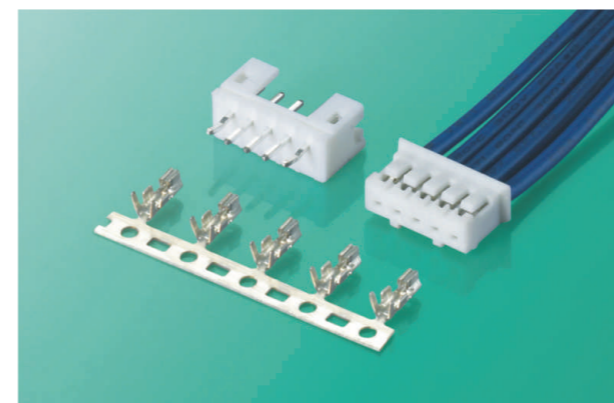

主要技术参数 (Main specifications)

- 使用导线范围 (Wire range): AWG#30~#24 #32~#28
- 额定电压 (Rated voltage): 250V
- 额定电流 (Rated current): 1A
- 接触电阻 (Contact resistance): $\leq 0.01 \Omega$
- 绝缘电阻 (Insulation resistance): $\geq 1000M\Omega$
- 耐压 (Withstanding voltage): 800V.AC
- 温度范围 (Temp range for usage): -25~85℃
- 适应基板厚度 (PC board thickness): 0.8~1.6mm

TP20061J-3(PH加长)

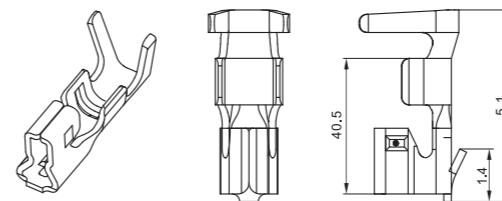

HP20061J-Y(PH加长)

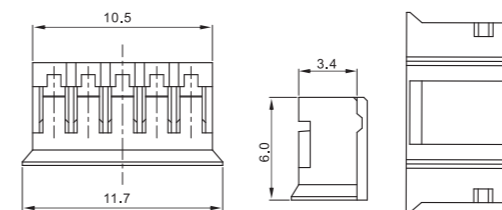

HW20061J-A(PH加长)

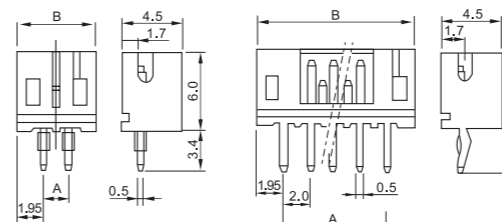

HW20061J-QA(PH加长)

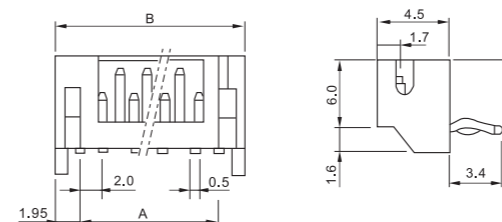

端子 (Terminal) (PH加长)

| 型号 Type | 适用电线范围 (Wire Range) | | 电线外径 (O.D of Wire ins) | Q' ty/reel |
|---------------|------------------------|-------|---------------------------|------------|
| | mm ² | AWG# | mm | |
| TP20061J-3(A) | 0.032~0.08 | 32~28 | 0.5~0.9 | 8000PCS |
| TP20061J-3(B) | 0.05~0.22 | 28~24 | 0.9~1.5 | 8000PCS |

塑体 (Housing) (PH加长)

| 线数 (Lines) | 型号 (Type) | 尺寸 Size(mm) | |
|---------------|--------------|-------------|------|
| | | A | B |
| 2 | HP20061J-2Y | 2.0 | 5.8 |
| 3 | HP20061J-3Y | 4.0 | 7.8 |
| 4 | HP20061J-4Y | 6.0 | 9.8 |
| 5 | HP20061J-5Y | 8.0 | 11.8 |
| 6 | HP20061J-6Y | 10.0 | 13.8 |
| 7 | HP20061J-7Y | 12.0 | 15.8 |
| 8 | HP20061J-8Y | 14.0 | 17.8 |
| 9 | HP20061J-9Y | 16.0 | 19.8 |
| 10 | HP20061J-10Y | 18.0 | 21.8 |
| 11 | HP20061J-11Y | 20.0 | 23.8 |
| 12 | HP20061J-12Y | 22.0 | 25.8 |
| 13 | HP20061J-13Y | 24.0 | 27.8 |
| 14 | HP20061J-14Y | 26.0 | 29.8 |
| 15 | HP20061J-15Y | 28.0 | 31.8 |

针座(Wafer) (PH加长)

| 线数 (Lines) | 型号 (Type) | | 尺寸 Size(mm) | |
|---------------|-----------------------|---------------------|-------------|------|
| | 直式 (Vertical type) | 弯式 (Curved type) | A | B |
| 2 | HW20061J-2A | HW20061J-2QA | 2.0 | 5.9 |
| 3 | HW20061J-3A | HW20061J-3QA | 4.0 | 7.9 |
| 4 | HW20061J-4A | HW20061J-4QA | 6.0 | 9.9 |
| 5 | HW20061J-5A | HW20061J-5QA | 8.0 | 11.9 |
| 6 | HW20061J-6A | HW20061J-6QA | 10.0 | 13.9 |
| 7 | HW20061J-7A | HW20061J-7QA | 12.0 | 15.9 |
| 8 | HW20061J-8A | HW20061J-8QA | 14.0 | 17.9 |
| 9 | HW20061J-9A | HW20061J-9QA | 16.0 | 19.9 |
| 10 | HW20061J-10A | HW20061J-10QA | 18.0 | 21.9 |
| 11 | HW20061J-11A | HW20061J-11QA | 20.0 | 23.9 |
| 12 | HW20061J-12A | HW20061J-12QA | 22.0 | 25.9 |
| 13 | HW20061J-13A | HW20061J-13QA | 24.0 | 27.9 |
| 14 | HW20061J-14A | HW20061J-14QA | 26.0 | 29.9 |
| 15 | HW20061J-15A | HW20061J-15QA | 28.0 | 31.9 |