

工程变更单号 ECN NO	变更说明 DESCRIPTION	版次 REV	发行时间 DATE	确认 ACCEPT	审核 CHECK	批准 APPROVAL
		A01				

针座图面

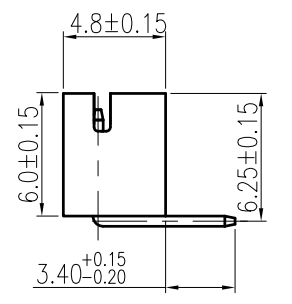
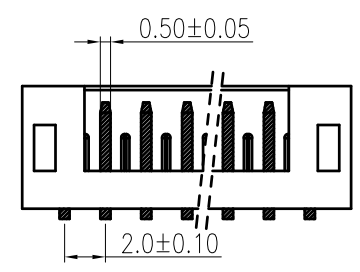
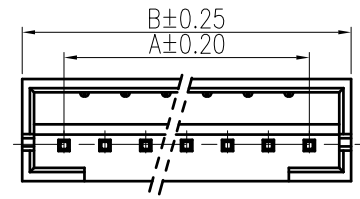
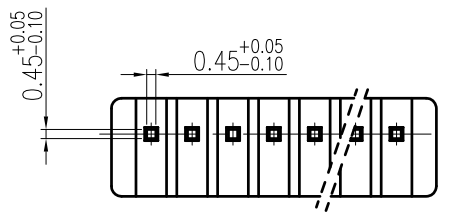
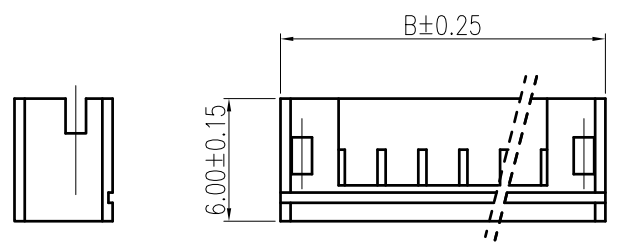
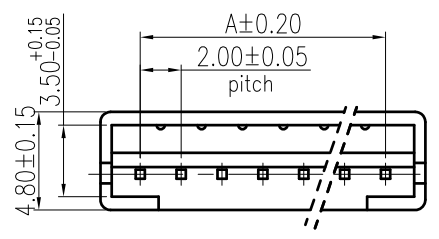
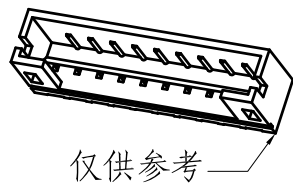

(表一)

线数	珠城型号	A	B	珠城料号	美的料号
2	HW20061J-2QA	2.00	5.90	242061021209	302301417286
3	HW20061J-3QA	4.00	7.90	242061031209	
4	HW20061J-4QA	6.00	9.90	242061041209	
5	HW20061J-5QA	8.00	11.90	242061051209	
6	HW20061J-6QA	10.00	13.90	242061061209	
7	HW20061J-7QA	12.00	15.90	242061071209	
8	HW20061J-8QA	14.00	17.90	242061081209	
9	HW20061J-9QA	16.00	19.90	242061091209	
10	HW20061J-10QA	18.00	21.90	242061101209	
11	HW20061J-11QA	20.00	23.90	242061111209	
12	HW20061J-12QA	22.00	25.90	242061121209	

Technical Requirements:

- Material : PA66 and Brass with tin plated
- Appearance : No Structure Deformation、 No obvious burr.
- Electrical Characteristics:
 - Rated Voltage:250V;
 - Rated Current:5A
 - Insulation Resistance: 1000M
 - withstand voltage:800V AC/1 minute
- Temperature Range:-25 ~ +90
- Dimensional Tolerance:GB/15055-94
- Applicable terminal and housing: TP2006/HP2006J
- Specification of the pin: 0.5*10.5 (right-angled)



尺寸	公差	尺寸	公差
DIM	TOL	DIM	TOL
.X	± 0.20	.X	± 2°
.XX	± 0.15	.X	± 1°
.XXX	± 0.10		
	± 0.05		

ZUCH 浙江珠城科技股份有限公司
Zhejiang ZUCH Technology Co., Ltd

文件编号 FILE NO	ZC-H-21	日期 DATE	产品名称 TITLE	Pin针座 (弯针, 无保护脚)
设计 DESIGN			成品料号 PART NO	版次 REV
审核 CHECK			见 (表一)	
批准 APPROVAL			比例 SCALE	1:1 单位 UNIT
			mm	

客户图